

This drawing should not be scaled. Dimensions to be verified on site. Any discrepancies should be referred to the Engineer prior to work being put in hand. This drawing is the property of Waterman Moylan Consulting Engineers Limited and is issued on the condition that it is not copied, reproduced, retained or disclosed to any unauthorized person, either wholly or in part without the consent in writing of Waterman Moylan Consulting Engineers Limited. Block 5, East Point Business Park, Dublin D03 H3F4 Ireland. 1-033 1 664 990.

NOTES:

- DO NOT SCALE. USE FIGURED DIMENSIONS ONLY.
- THIS DRAWING IS TO BE READ IN CONJUNCTION WITH ALL OTHER RELEVANT ARCHITECTURAL AND ENGINEERING DRAWINGS.
- ALL PIPE MATERIALS SHALL BE IN ACCORDANCE WITH SECTION 3.9 OF THE IRISH WATER CODE OF PRACTICE FOR WATER INFRASTRUCTURE. WATERMAINS SHALL BE EITHER DUCTILE IRON (DI) OR POLYETHYLENE (PE), WITH PE80 OR PE100 RATING (MDPE, HDPEOR HPPE). ALL PLASTIC WATER PIPES SHALL BE BLUE IN COLOUR.
- ALL SERVICE CONNECTIONS TO BE 25# HDPE(SDR-17).
- ALL WATERMAINS UNDER ROADS OR AT ROAD CROSSINGS TO BE HDPE OR DUCTILE IRON.
- HDPE DISTRIBUTION PIPES TO BE PE-100(SDR-17).
- DUCTILE IRON PIPES TO IS EN 545 WITH C40 POWER RATING.
- AIR VALVE AND HYDRANTS COVERS, WHERE LOCATED IN GRASS AREAS, SHALL BE SURROUNDED BY A CONCRETE PLINTH, 200mm ALL ROUND AND 100mm DEEP FORMED WITH C20/25 CONCRETE, 20mm AGGREGATE SIZE, BEDDED IN CLAUSE 804 MATERIAL. THE PLINTH SHALL INCORPORATE MILD STEEL REINFORCED LINKS AND SHALL HAVE BULL-NOSE FINISH AROUND ITS EXTERNAL PERIMETER.
- THRUST BLOCKS SHALL BE PROVIDED AT EACH BEND ALONG THE COURSE OF THE WATERMAIN.
- PLANTING ADJACENT TO WATER INFRASTRUCTURE SHALL COMPLY WITH IRISH WATER STANDARD DETAIL STD-W-12A.
- HORIZONTAL AND VERTICAL SERVICE LAYOUT DISTANCES SHALL BE AS PER IRISH WATER STANDARD DETAIL STD-W-11.
- IT IS THE CONTRACTORS RESPONSIBILITY TO ENSURE THAT ALL WORKS ARE CONSTRUCTED IN ACCORDANCE WITH THE IRISH WATER CODE OF PRACTICE AND STANDARD DETAILS. THE CODE OF PRACTICE AND STANDARD DETAILS ARE AVAILABLE TO DOWNLOAD FROM THE IRISH WATER WEB SITE AT WWW.WATER.IE/CONNECTIONS/DEVELOPER-SERVICES/ WHERE THE DETAILS CONTAINED ON THIS DRAWING DIFFER FROM THE IRISH WATER CODE OF PRACTICE OR STANDARD DETAILS THIS MUST BE BROUGHT TO THE ATTENTION OF THE ENGINEER IMMEDIATELY. IRISH WATER STANDARDS WILL TAKE PRECEDENCE.

LEGEND:

- XXXmm Ø PROPOSED 150# HDPE WATERMAIN WITH PIPE SIZE
- XXXmm Ø PROPOSED 100# HDPE WATERMAIN WITH PIPE SIZE
- XXXmm Ø EXISTING WATERMAIN WITH PIPE SIZE
- SV PROPOSED SLUICE VALVE
- ScV PROPOSED SCOUR VALVE
- H PROPOSED HYDRANT
- AV PROPOSED AIR VALVE
- M PROPOSED WATER METER
- BB PROPOSED BOUNDARY BOX AND CONNECTION

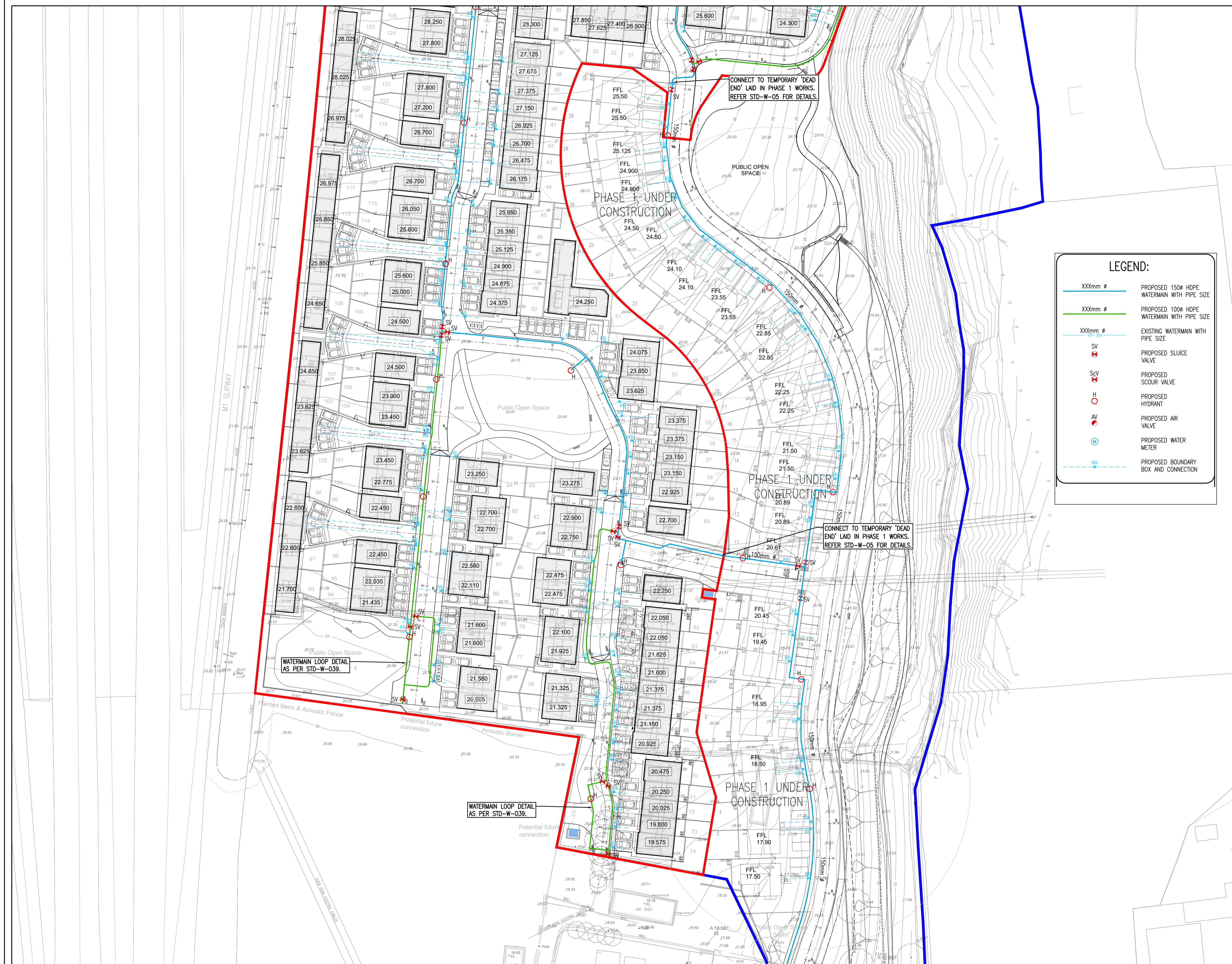

C	09/05/23	ISSUED FOR PLANNING	NS	MD
B	08/05/23	REVISED TO SUIT COMMENTS FROM IRISH WATER	NS	SDN
A	30/04/24	REVISED FOLLOWING COMMENTS RECEIVED FROM IRISH WATER	NS	SDN
Rev	Date	Description	By	CHK

PROPOSED RESIDENTIAL DEVELOPMENT AT OLD SLANE ROAD, DROGHEDA, CO. LOUTH

PHASE 2 WATERMAIN LAYOUT AND LEVELS SHEET 1 OF 2

Client: LAGAN HOMES TULLYALLEN LTD.



BLOCK 5, EASTPOINT BUSINESS PARK, ALFIE BYRNE ROAD, DUBLIN D03 H3F4 IRELAND. Tel: (01) 864 8900. Email: info@waterman-moylan.ie www.waterman-moylan.ie

PLANNING			
Designed By	NS	Approved	MD
Drawn By	NS	Date	APRIL 2024
Project	Originator	Volume	Level
OSR - WMC - ZZ - ZZ-DR - C - 3301			
Waterman Ref			23-067
Scales @ A1			1:500
Revision			C

Drawing Location: M:\Projects\3301\3301-067 Old Slane Road\Drawings\Watermain - Moylan\Civil\Autocad Drawings\Phase 2\OSR-WMC-ZZ-ZZ-DR-C-3301 & 3302 Watermain Layout Sheet 1 & 2.dwg
Date: May 09, 2024 10:46am